

Parking entrance



Outdoor Parking directions:

- Entrance is located right before 17, Boulevard F.W. Raiffeisen- L-2411 Luxembourg
- The entrance will be on your right between the premises of Deloitte and Ocorian Luxembourg. (You will find hereto some pictures of the entrance for your reference).

Indoor Parking directions:

- Inside the parking, please take the second parking entrance on your left and follow the signs "CMS".
- The parking spaces **2, 7, 12** and **13** are available for our visitors.
- After parking, follow the signs for "CMS" until you reach the elevator that will take you to the Reception area on the 6th floor.

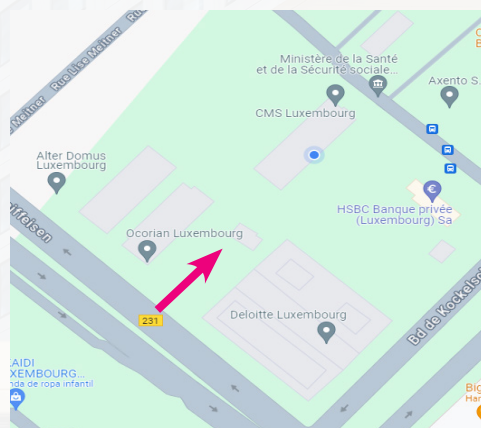
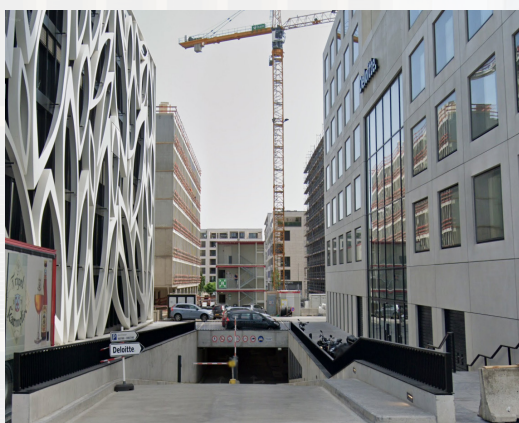

If you need any assistance, please call our reception desk at **+352 26 27 53 1**

Directions

From the Airport

Findel – Luxembourg Airport

The airport is located 12 km from the office.

- Taxi – the journey is approx. 15 minutes.
- Bus 29, 302 – the journey is approx. 2 minutes.

Bus stop: "Gasperich, Gerhard Mercator".



By car

If you are travelling by car, please enter our address **5, Rue Charles Darwin L-1433 Luxembourg** into your satnav for directions to the office. Please note that the entrance to the parking lot is around the block. You also have the option to park for free at the Cloche d'Or Shopping Center parking lot.



By train and tram

From the Gare Centrale

The train station is located 2,4 km from the office.

- Taxi – the journey is approx. 5-10 minutes.
- Tramway – the journey is approx. 20 minutes
Tram stop: "Lycée Vauban"
- Bus 28, 29 – the journey is approx. 10 minutes.
From: "Luxembourg, Gare Centrale"
Bus stop: "Gasperich, Gerhard Mercator".
- Bus 20, 22 – the journey is approx. 10 minutes.
From: "Luxembourg, Gare Rocade"
Bus stop: "Gasperich, Hildegard von Bingen".



From the Howald train station

The train station is located 1,4 km from the office.

- Walking – it is an approx. 20 minutes' walk.
- Taxi – the journey is approx. 5 minutes.
- Bus 24, 28, 29 – the journey is approx. 5 minutes.
Bus stop: "Gasperich, Gerhard Mercator"